



INSTALLATION GUIDE and USER MANUAL
of the
MAGIC SAT EASY



TABLE OF CONTENTS	Page
Information.....	2
List of accessories	3
Important notice.....	4
Assembly instructions.....	5
Installation with cables through the centre of the base plate.....	7
Installation with cables coming out sideways	9
Connections	10
Important information for proper antenna tracking.....	13
Tips on the best use of Magic Sat Easy	14
Tips on the best use of Magic Sat Easy	14
Installation tips.....	14
Magic Sat Easy – rear view	15
Magic Sat Easy – control board.....	15
Operation of Magic Sat Easy.....	16
Turning on the Magic Sat Easy	16
Selecting the satellite	16
Seeking the satellite.....	17
Parking the antenna.....	17
Turning off the Magic Sat Easy	17
Error code display	17
Troubleshooting.....	18
Technical specifications.....	18

Information

Congratulations on your purchase! Magic Sat Easy is among the most technologically advanced products in the field of satellite TV reception. This handbook has been prepared to provide information on how to install, use, maintain and technical specifications your Magic Sat Easy system.

For additional information, please contact your local dealer or directly the manufacturers:

TELECO s.p.a.
Via E. Majorana 49
I-48022 LUGO (RA)

Web site: www.telecogroup.com
Technical attendance: lab@telecogroup.com
Technical attendance: 899.899.856

TELECO s.p.a. declines all responsibility for any errors contained in this manual. All the contained information are up to the dates of printing and of the above-mentioned software revisions. TELECO s.p.a. reserves the right to introduce any modification made necessary by the development of its products.

List of accessories

Magic Sat Easy is delivered inside a cardboard case that has been specially made to protect it from knocks and pressure. The following accessories are supplied:

- 1 External motor-driven unit
- 2 50 - 65 - 85 cm dish
- 3 Universal LNB
- 4 Control unit
- 5 Wall-mounted control panel
- 6 Motor Connection Cable
- 7 Antenna-Control unit connection lead
- 8 Power Supply Cable
- 9 Control unit/Wall panel connection cable
- 10 Waterproof box to pass leads through to interior
- 11 Heat-shrinking sheaths
- 12 Roof attachment plate
- 13 No. 4 stainless steel Locknuts M6
- 14 No. 4 stainless steel Screws and Locknuts - M5 → Ø 50 cm / M 6 → Ø 65-85 cm
- 15 User's manual



Important notice

Magic Sat Easy is packaged in two separate cartons for transport reasons:

- a) the first package contains the driving unit with all the cables, and the control box.
- b) the second package only contains the dish.

- It is important to check that the dish has not been damaged during transport when the package is opened. In particular, check the following well:
- By resting the dish edge against a flat surface (e.g. the floor or a wall) check that it makes contact to the surface all around. If it is not so, try and make the edge level, without denting the dish, or call our After-Sales Service.



- After checking that everything is in order, install the dish on the driving unit as follows:
 - 1) Temporarily connect the Control Box to the driving unit through the grey motor cable.
 - 2) Connect the control board to the Control Box through the RJ45 cable.
 - 3) Power the Control Box using a battery.
 - 4) Press the switch-on button and wait for the dish support mast to rise.
 - 5) Once the desired position has been reached, turn off the Magic Sat Easy via the same button.
 - 6) Secure the dish to the mast and screw down the four supplied screws.
 - 7) Turn the unit on again and wait for the antenna to close.
 - 8) Disconnect the the Control Box, the battery and install the driving unit on the vehicle.



Assembly instructions

- 1) Position the Control Box in an easy accessible, ventilated compartment.
- 2) Place the control board comando in an easily accessible, visible position.
- 3) On the roof of the vehicle, choose a free area large enough to allow the antenna to revolve (Fig. 2)
- 4) Install the connection cables (Grey and White) until you reach the OUTSIDE UNIT installation area.

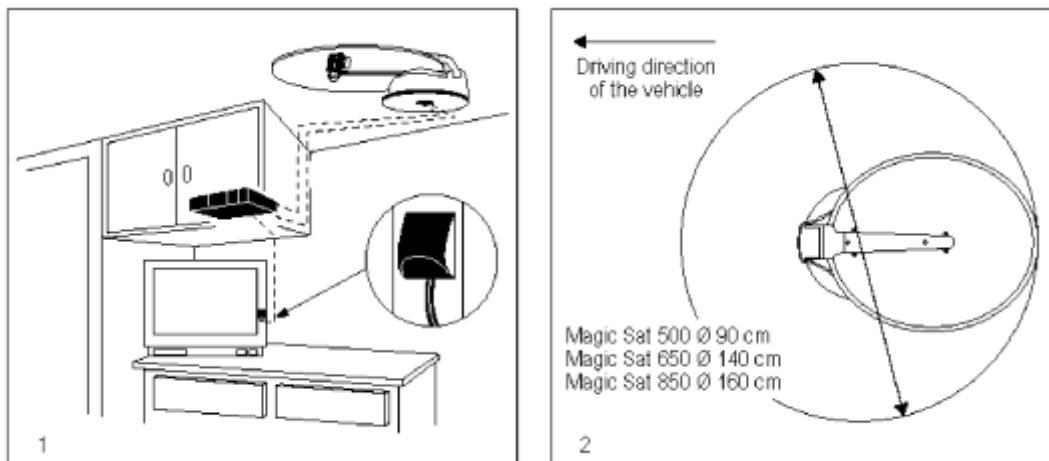
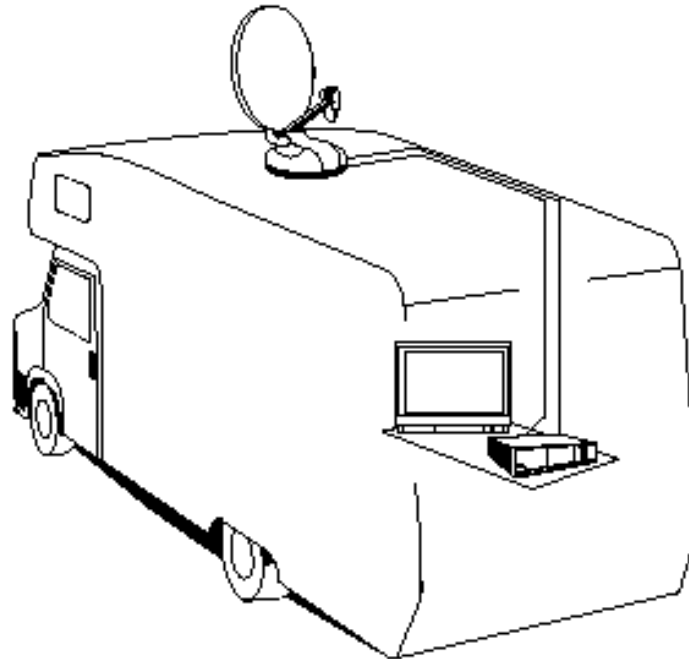

- 5) Clean the roof carefully in the area the OUTSIDE UNIT is to be installed in.
- 6) Remembering that the OUTSIDE UNIT must be fastened as shown on figure 3, remove the BASE PLATE from the outside unit, unscrewing all 4 nuts. Position the base plate as shown on figure 4, with the short side towards the driving direction of the vehicle.

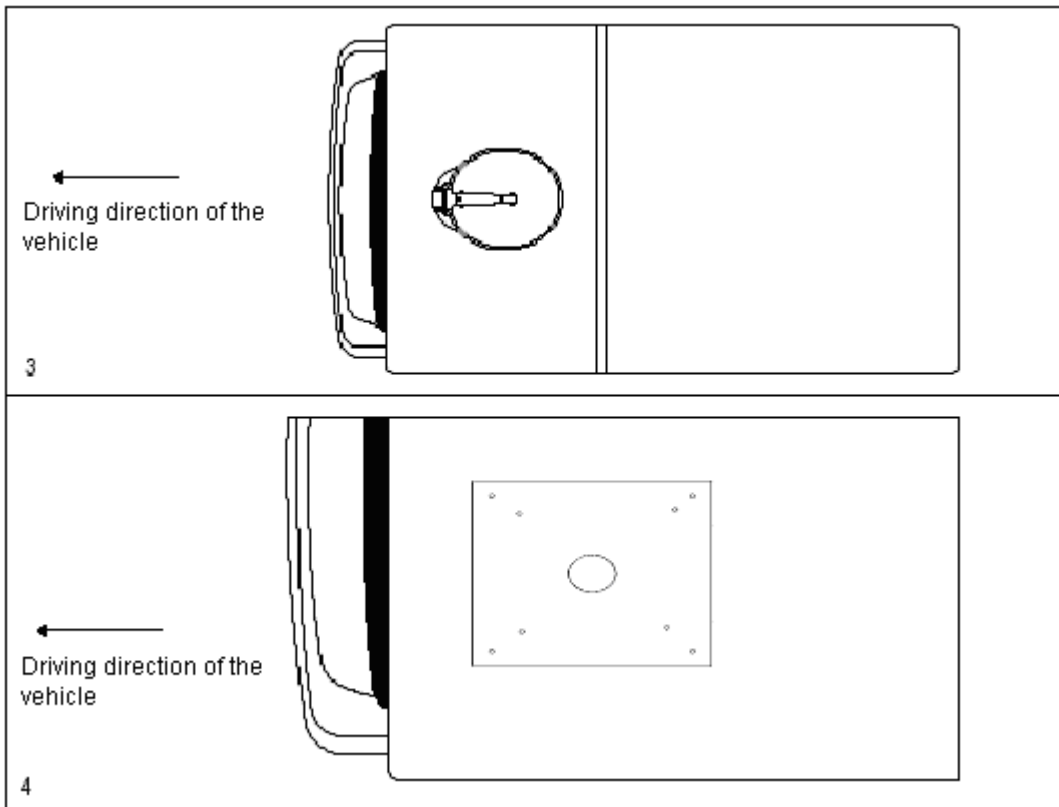

- 7) Clean the lower part of the BASE PLATE carefully, applying a layer of glue on the whole surface (e.g. SIKAFLEX).
- 8) Fasten the BASE PLATE to the roof (short side towards the vehicle driving direction), now fasten the external powered unit to the four stud bolts of the plate, using the four nuts supplied with the equipment.

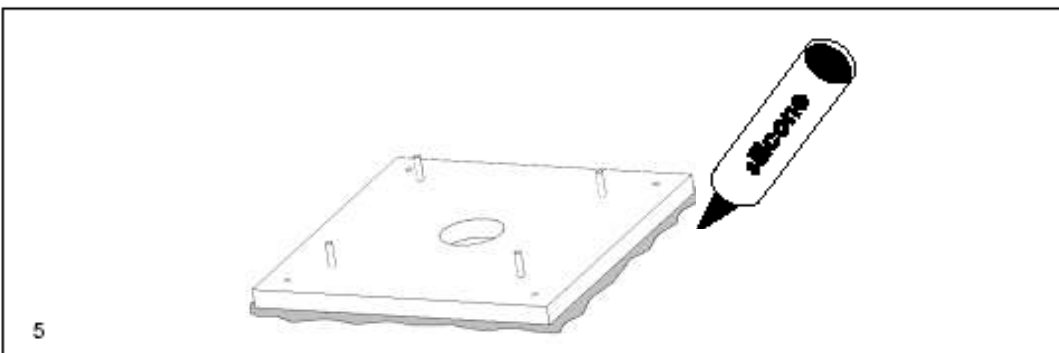

- 9) Apply a layer of silicone all around the BASE PLATE in order to make it completely waterproof (Fig. 5)

Installation with cables through the centre of the base plate

- 10) Connect the Grey and White cables, coming from inside the vehicle (Fig. 6) to the two cables of the outside unit, waterproofing them using two pieces of HEAT-SHRINKING TUBE (Fig. 7)

WARNING When performing this operation, do not draw the cables coming from the centre of the outside unit forcefully, as this might pull them out.

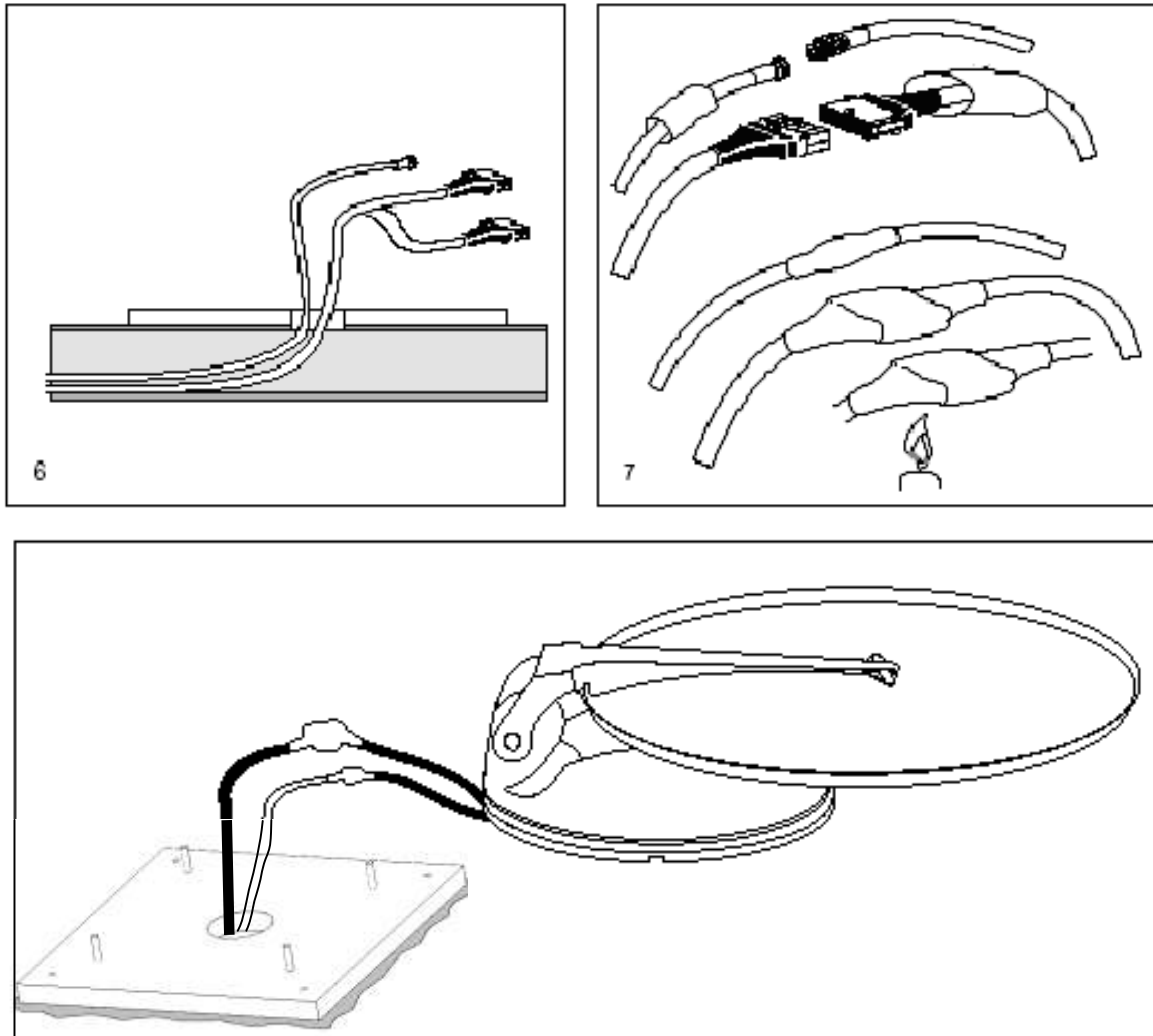

11) Install the OUTSIDE UNIT on the base plate, remembering that:

- a) The right position is the one shown on (Fig. 9)
- b) Apply an abundant layer of silicone on both the base plate and the bottom of the driving unit (Fig. 10) so as to prevent any infiltration by water. Screw down the 4 supplied nuts by the screws and tighten properly (Fig. 11)

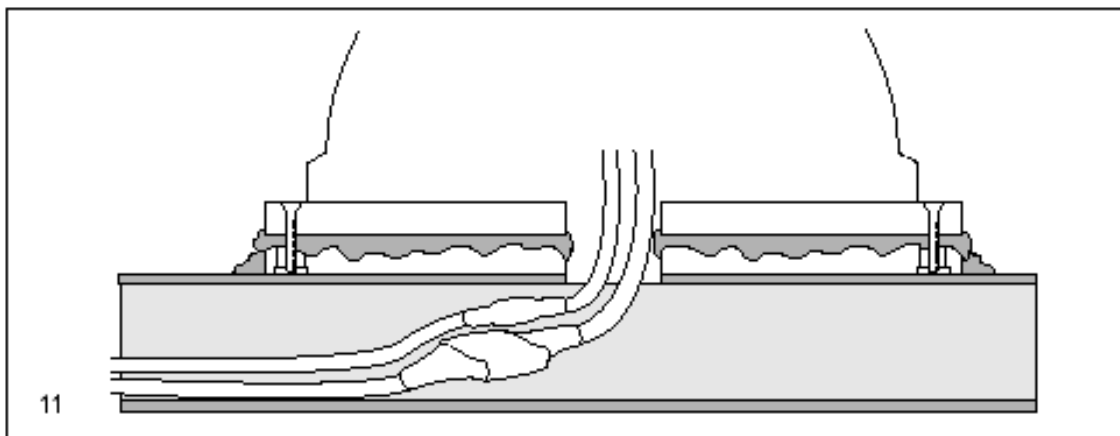
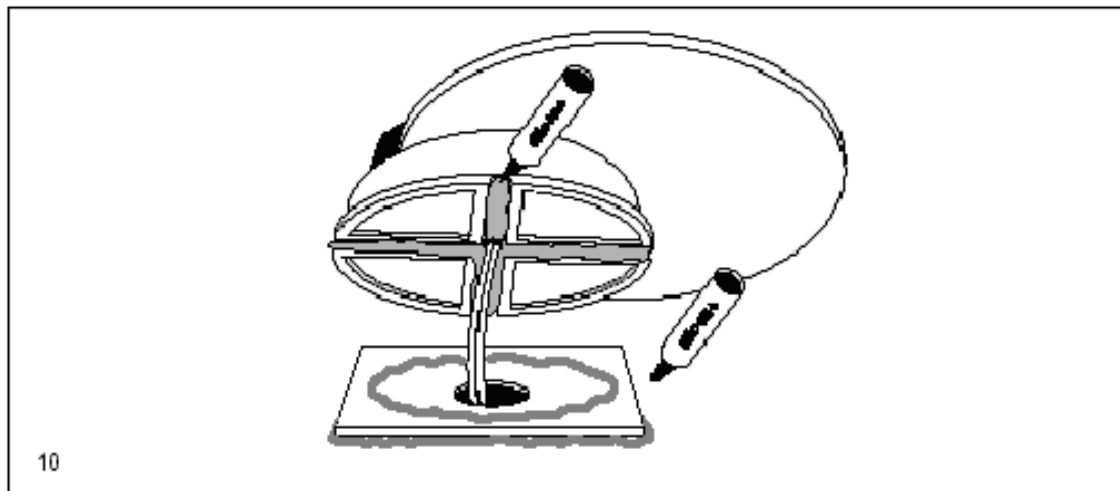
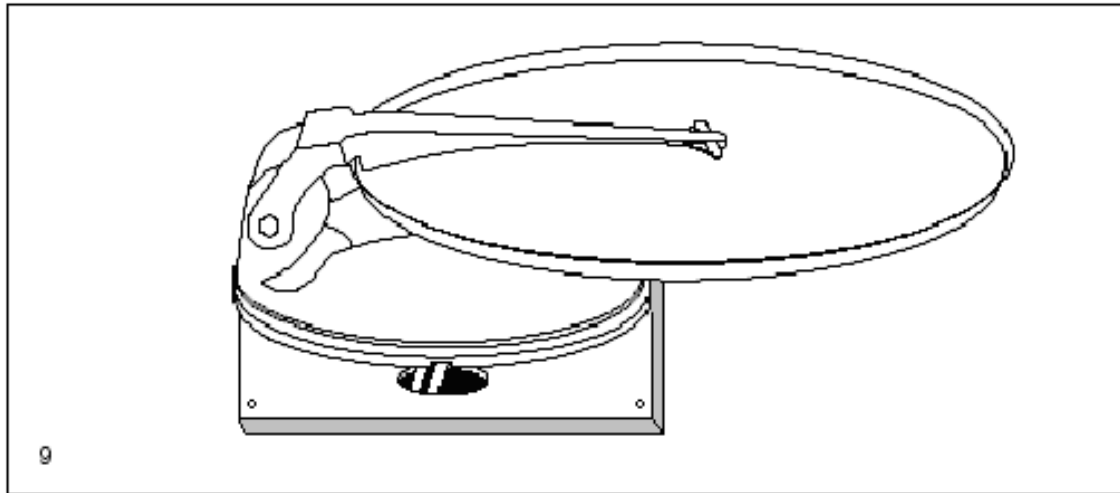

Installation with cables coming out sideways

- 12) Fasten the OUTSIDE UNIT on the base plate and lead the two cables through one of the 4 existing grooves, according to the position as shown on Fig. 12.

WARNING: When performing this operation, do not draw the two cables forcefully, as this might pull them out.

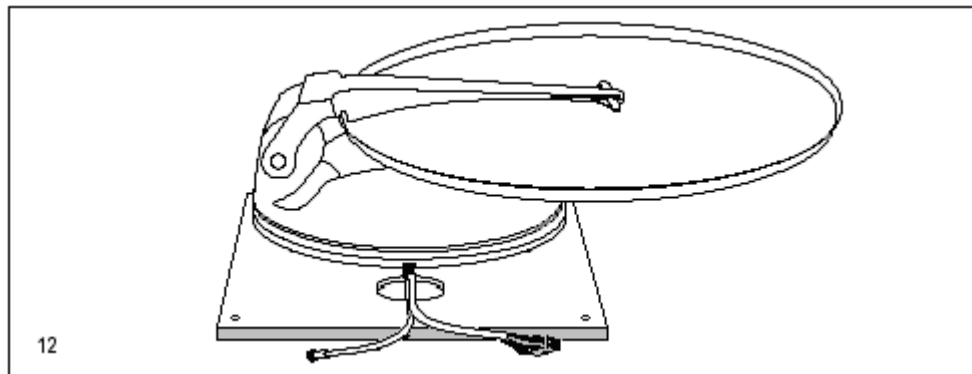

- 13) Connect the two cables coming from the centre of the OUTSIDE UNIT to the two supplied extensions, waterproofing the connectors using the two pieces of heat-shrinking tube.

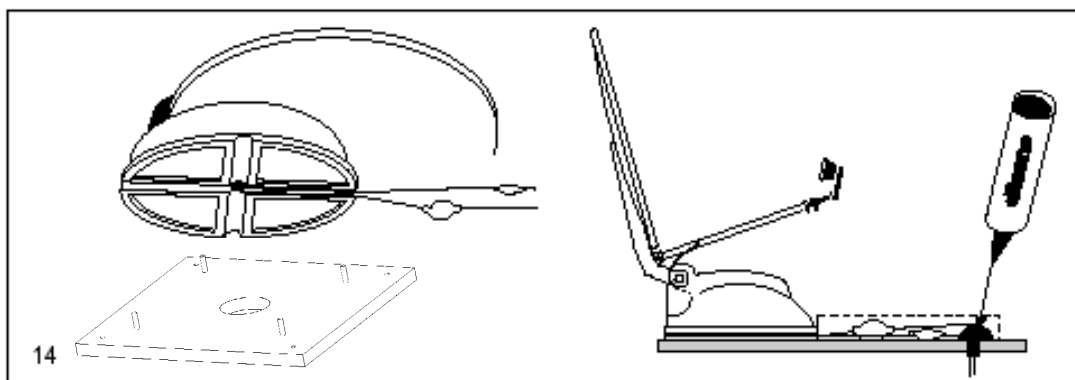
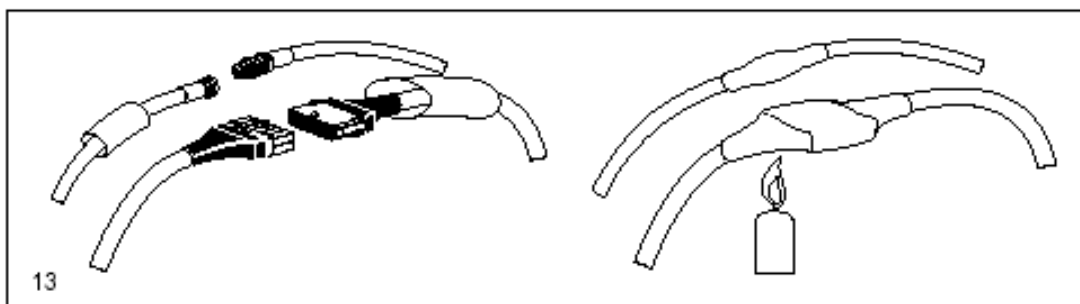

- 14) Accomodate the cables into a protection raceway up to the point where the cables go into the vehicle, using the suitable supplied fairlead.

- 15) Seal the fairlead carefully so as to prevent any infiltration by water.

Connections

- 16) Connect the grey cable (motors) to the MOTOR UNIT connector and the white coaxial cable (antenna) to the LNB connector of the Control Box.
- 17) Connect the Receiver to the RECEIVER connector (Fig. 16). You can connect any satellite receiver, either digital or analog.
- 18) Connect the BLACK cable of the Control Box to the NEGATIVE POLE of the vehicle 12 Volt Battery, and the RED cable to the POSITIVE POLE + (remember not to mix the + and - poles up), using 2 cables of a cross section of 2.5² (Fig. 15).
- 19) The GREEN safety cable of the Control Unit must be connected to the consensus of the vehicle startup console (in many cases such consensus is located on Pin 15 in the main terminal board). In this way, whenever the motor is started, this cable receives a positive + 12 Vdc voltage, which will automatically lower the antenna and lock all functions of the Control Unit simultaneously (Fig.15).

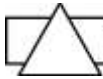

WARNING

Any connection made in points other than as indicated (e.g. on the alternator) can give rise to equipment malfunction and/or damage resulting in loss of the warranty.

Electric connection

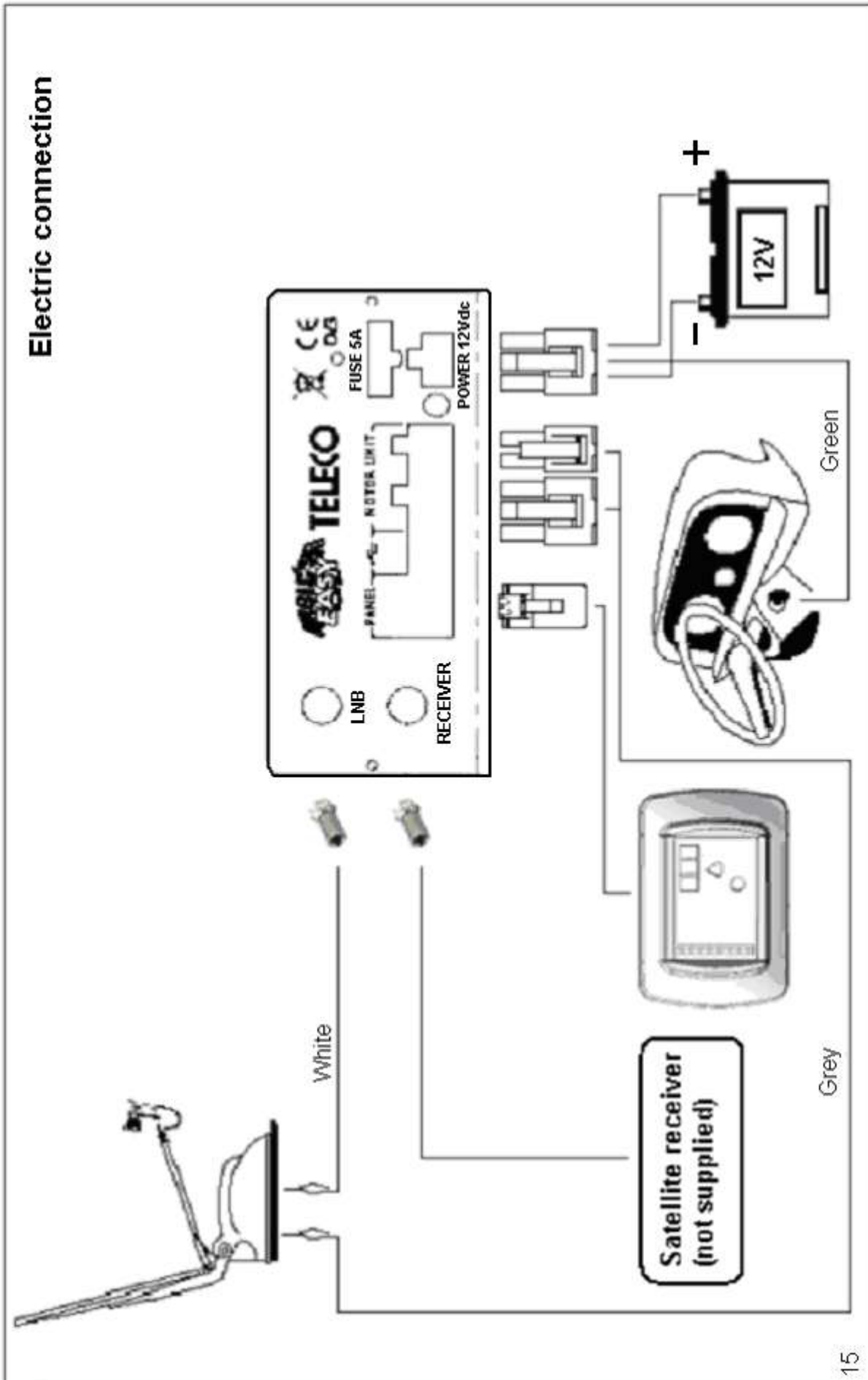

15



WARNING

This technical note is to call the attention of the installation personnel to certain details of Magic Sat Easy installation. During installation, you must take the following precautions:

The power supply cable must come directly from the battery and be of a minimum cross-section of 5 sq.mm. Only the Magic Sat Easy must be connected to this cable; all the other devices must be connected to another power supply cable.

The cable connecting the driving unit to the Magic Sat Easy Control Box must NEVER be cut for any reason whatsoever: should the cable turn out to be too long, wind the extra part into a coil in a free area of the vehicle.

Leave a little cable in the driving unit area; should any technical operation be required, it will make it easier to remove the driving unit.

Also, before checking its operation, we suggest you make sure that:

The outside converter (also called LNB) has been installed properly and locked into its plastic lock nut. Remember that the outside converter has its own assembly position which must be complied with. Otherwise you will not receive any signal.

The preset assembly position of the converter is along the median line of the dish (Fig. A) and in this configuration the Magic Sat Easy system operates properly in most European countries. If however you are in areas which are very far from the orbital position of the satellite, you could need to adjust the angle of the converter. In particular, if you wish to receive any transmission from the Astra 19E, Astra 28E or Hot Bird 13E satellites and you are in Portugal or Morocco, you should adjust the converter angle as shown on Fig. B2, whereas if you are in Turkey, you should set the converter on the B1 position for the same satellites.

Below you will find a table to help you setting the best angle Place Position HotBird13E Astra 19E ASTRA 28E

Place	Position	HotBird 13E	Astra 19E	Astra 28E
Lisbon	B2	25	28	37
Casablanca	B2	27	34	41
Ankara	B1	22	15	5

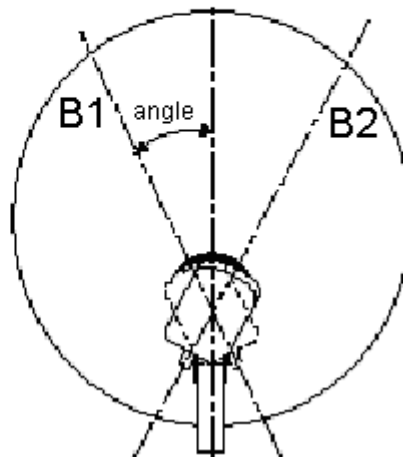
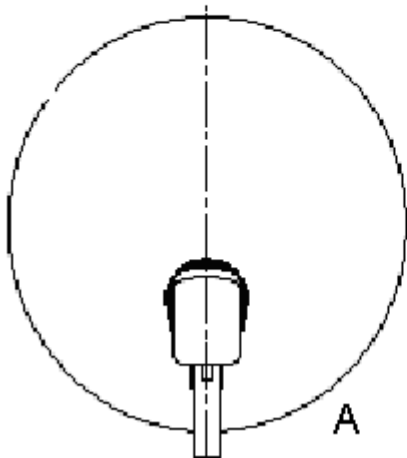

Important information for proper antenna tracking

Before performing antenna tracking operation, make sure you have positioned your vehicle so that the view towards the South (where Satellite signals come from) is free from any nearby obstacle (trees, houses, etc.). This way, the antenna will be free to receive signals coming from the satellite.

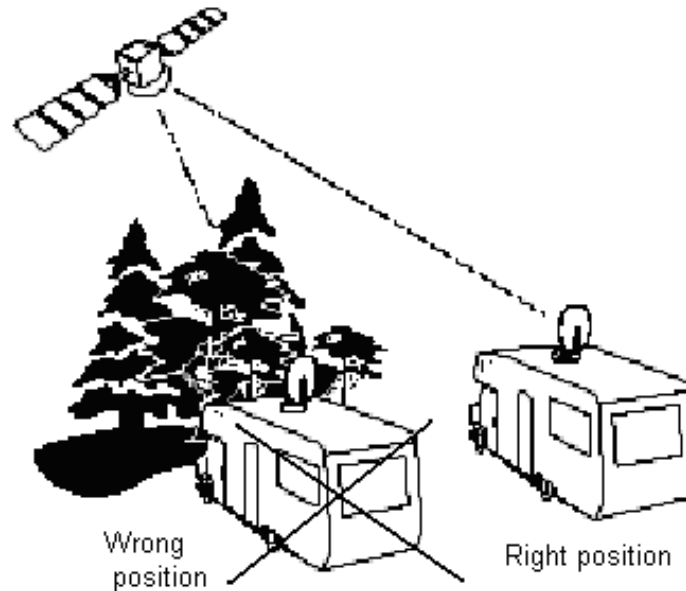

It is also important to know that satellites do not transmit with the same intensity throughout Europe, so if you are outside the reception area, your Magic Sat Easy search might be unsuccessful. The reception areas for each Satellite can be found on the main magazines dealing in this line of business. Also remember that the larger the dish, the more reception area is available.

WRONG POSITION



RIGHT POSITION



Tips on the best use of Magic Sat Easy

When you park your vehicle, make sure that:

- 1) No obstacle (for example trees) is too near your antenna, preventing it from moving freely. No metal or glass wall is very near (about 5 m) the antenna, since this would act as a mirror for satellite signals and could induce the antenna to stop towards it.
- 2) Remove any snow or ice from the Magic Sat Easy before actuating it in order to avoid wasting battery power trying to lift it.
- 3) If you decide to turn the engine of your vehicle on in order to re-charge its batteries, with the safety cable connected to the ignition key, the antenna, if lifted, will come down automatically and it will not be possible to lift it again as long as the engine is running.
- 4) Make sure that your batteries are always sufficiently charged, since, if the voltage falls below 10 Volts, the Magic Sat Easy electronic safety circuit will prevent the antenna from rising.
- 5) Should you use 12 Volt power supply instead of batteries, be careful to use stabilized power supply being able to provide 5 A continuously and at least 10 A for short periods. At all costs, avoid using low quality, non stabilized battery chargers.

Installation tips

- 1) The control board must be installed in an easily accessible area.
- 2) Do not install the Control Box in areas where liquids can be spilled, since this could cause irreparable damage.
- 3) Do not install the Control Box in very small, unventilated compartments, since overheating could compromise its functionality.

Magic Sat Easy – rear view

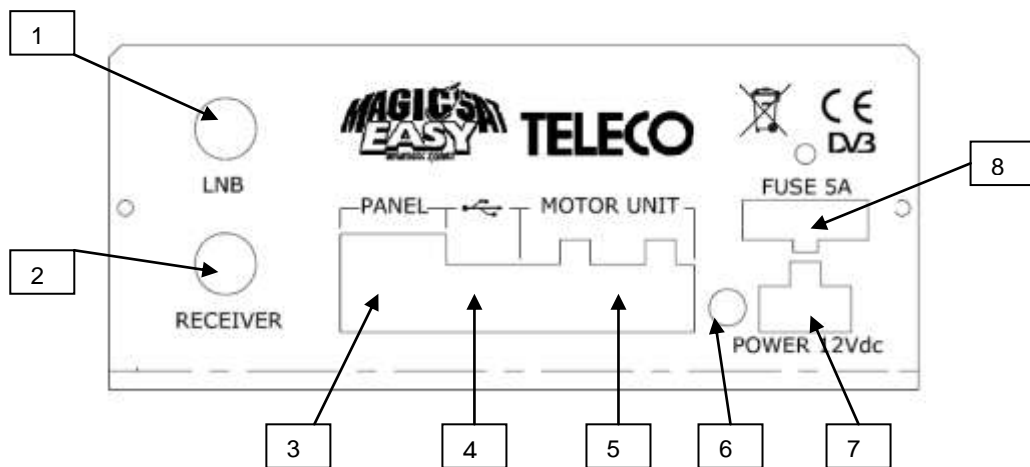

- 1) F type connector – input from LNB converter of the driving unit
- 2) F type connector – signal output to be connected to any satellite receiver
- 3) RJ45 type connector – connected to the control board
- 4) USB B type connector – connection to a PC
- 5) MiniFIT jr. double connector– connection to the driving unit
- 6) Diagnostics button (for technical staff only)
- 7) MiniFIT jr. connector– power supply input
- 8) 5 A blade fuse

Magic Sat Easy – control board

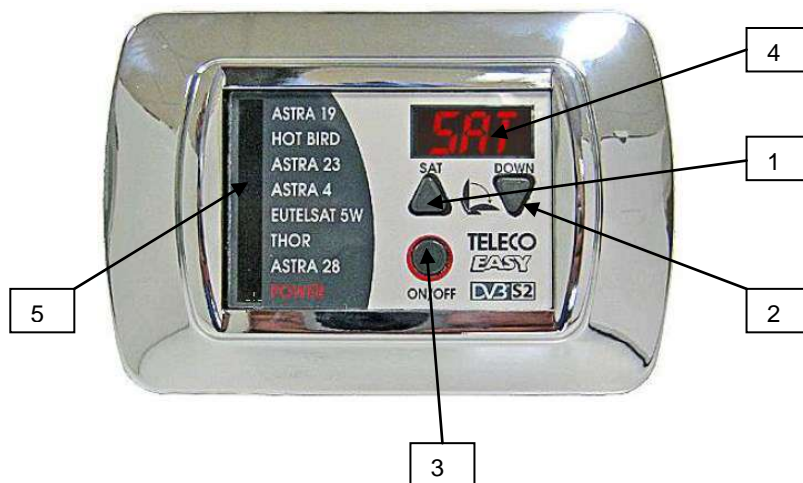

- 1) Satellite selection button
- 2) Antenna parking button
- 3) Switch-on button
- 4) Display
- 5) Selected satellite indicators

Operation of Magic Sat Easy

Magic Sat Easy is a completely automatic satellite tracking system and is able to track satellites which send a QPSK modulated signal, according to the DVB-SI EN 300 468 standard. The main operations that your Magic Sat Easy system is able to carry out are the following:

- Satellite Seeking
- Antenna parking

All the operations are carried out via the control board.

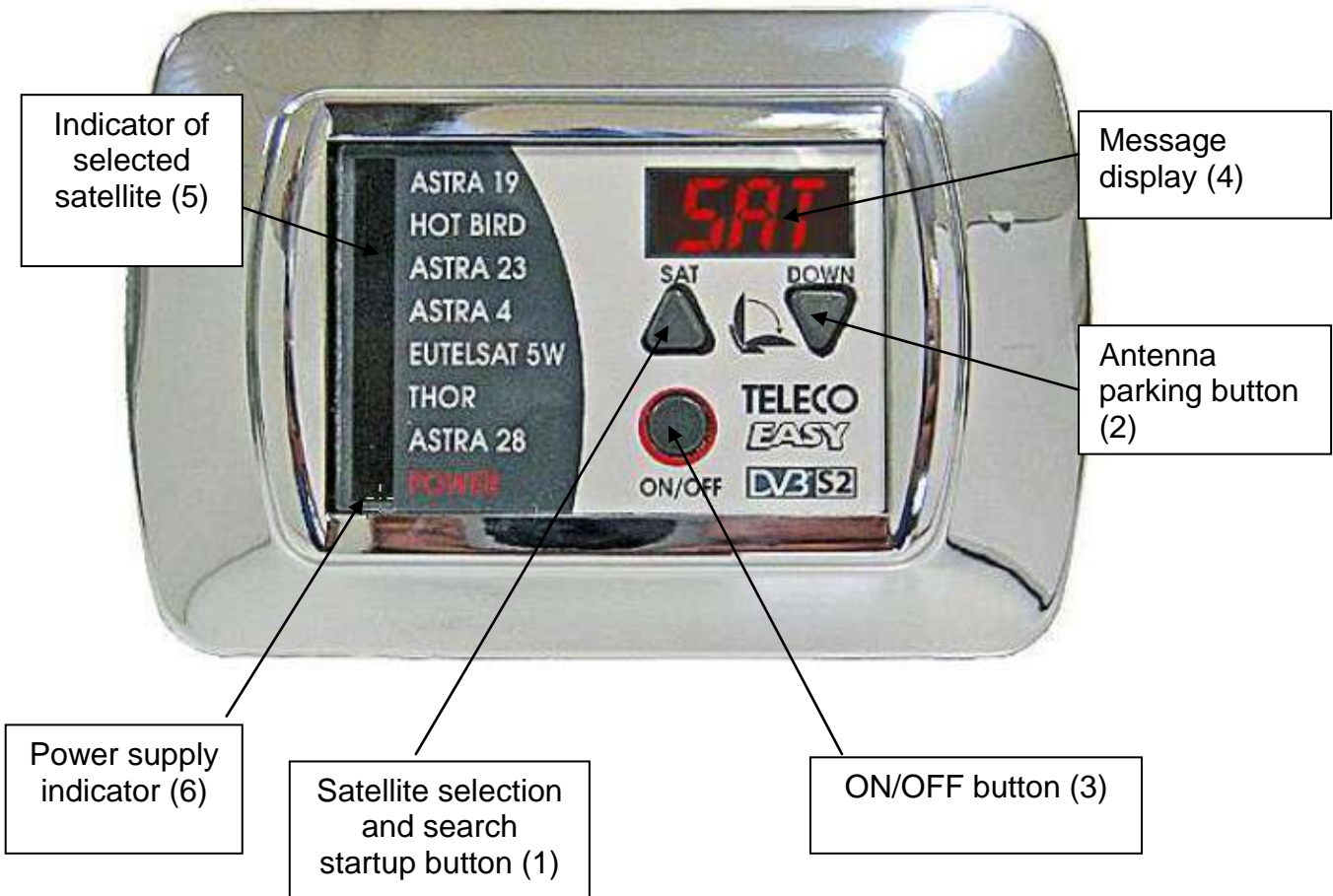

Turning on the Magic Sat Easy

To turn on the Magic Sat Easy system, press the button (3). Upon pressing the button and for 1 second time, all signal lights will go on to allow you to check the proper operation of the board. After this step, the message ON will appear on the display and the red power supply indicator (6) will go on .

Selecting the satellite

When the antenna is in parking condition (if it is not in parking condition, the time you turn the engine ignition key the Magic Sat Easy will close the antenna), a green signal light (5) will start blinking beside the name of the satellite; this means that the system is ready to search for the corresponding satellite. The user can change the satellite by pressing the button (1) several times until the blinking light is by the name of the selected satellite. If the

light is already on the selected satellite, no further selection is needed; after a few seconds the signal light will start blinking at a higher frequency and the antenna will start searching for the satellite. You can even change the satellite during a search, always pressing the button (1).

Seeking the satellite

During the seeking stage, the green signal light by the name of the satellite blinks fast, while the message ON appears on the display (4) followed by an animated bar which indicates the rotation of the antenna.

The antenna will stop moving as soon as it finds the satellite; in this case the message SAT will be brought to the display and the green signal light will remain on without blinking. At this point the satellite receiver can be turned on and used as if you were at home. The position of the antenna will be stored in memory for faster tracking, should the antenna be parked.

Parking the antenna

If you wish to park the antenna, press the button (2). In this case the antenna will be set in travel position and the message OFF will appear on the display.

Turning off the Magic Sat Easy

If you wish to turn off the Magic Sat Easy, press the button (3) and make sure that all signal lights are off. In this case the antenna remains in the position it was before turning off. Proper connection of the green safety cable ensures that the antenna is closed as long as the vehicle moves.

Error code display

If some operations have not been completed due to any malfunctions or troubles, the control board brings any error codes to the display. Such error codes have the following meaning:

ER1	No satellite found. You should check that the Magic Sat Easy system is positioned in such a way as to receive the desired satellite
ER2	The raising motor is jammed. Make sure that no foreign matters hinder regular movement
ER3	The rotation motor is jammed. Make sure that no foreign matters hinder regular movement
ER9	During the switch-on stage a fault occurred in the driving motor. Make sure that no foreign matters hinder regular movement.

Troubleshooting

- If the Magic Sat Easy has not found the satellite after a complete search, check the following:
 - a) Is the view towards the South free from any obstacle?
 - b) Is the place you are at within the reception area of the satellite you have chosen?
 - c) Is the cable connecting the LNB to the antenna firmly fastened? It could have been ripped off or come loose because of contact with an unexpected obstacle.
 - d) Are all the connections on the Control Box properly set up?

- If the antenna has stopped after performing tracking, but neither messages nor images appear on the screen:
 - a) Have you switched your receiver on ?
 - b) Have you switched your TV set on ?
 - c) Have you selected the right satellite ? Make sure that the services you wish to receive are really available on the required satellite.

- If the control board does not turn on when you press the switch-on button, check the following:
 - a) Are the RED and BLACK cables properly connected to the battery? The RED cable must be on the + pole, the BLACK cable on the – pole
 - b) Should you have mixed up the cables, first disconnect them, replace the safety fuse on the bottom of the CONTROL BOX using a similar one (5 A), then re-connect the RED and BLACK cables properly to the battery.
 - c) Is the engine on your vehicle running? Turn it off, since this means the safety system which keeps the antenna down is operating.

Technical specifications

SPECIFICATIONS

Search system	Fully automatic, NID recognition according to the DVB-SI EN 300 468 specifications with DVBS2 tuner.
Satellites which can be set	7
Extensions	USB 1.0 Port Control board

MISCELLANEA

Power supply	12Vdc –20 +30 %
Absorbed current	5 A max.
Current in stand-by	< 5 mA
Fuse	5 A
Dimensions	160 x 187 x 58 mm (control box) 120 x 35 x 80 mm (control board)
Weight	< 1 kg (control box and control board) < 17 kg (outside driving unit)

MagicSat Easy

Tav.1

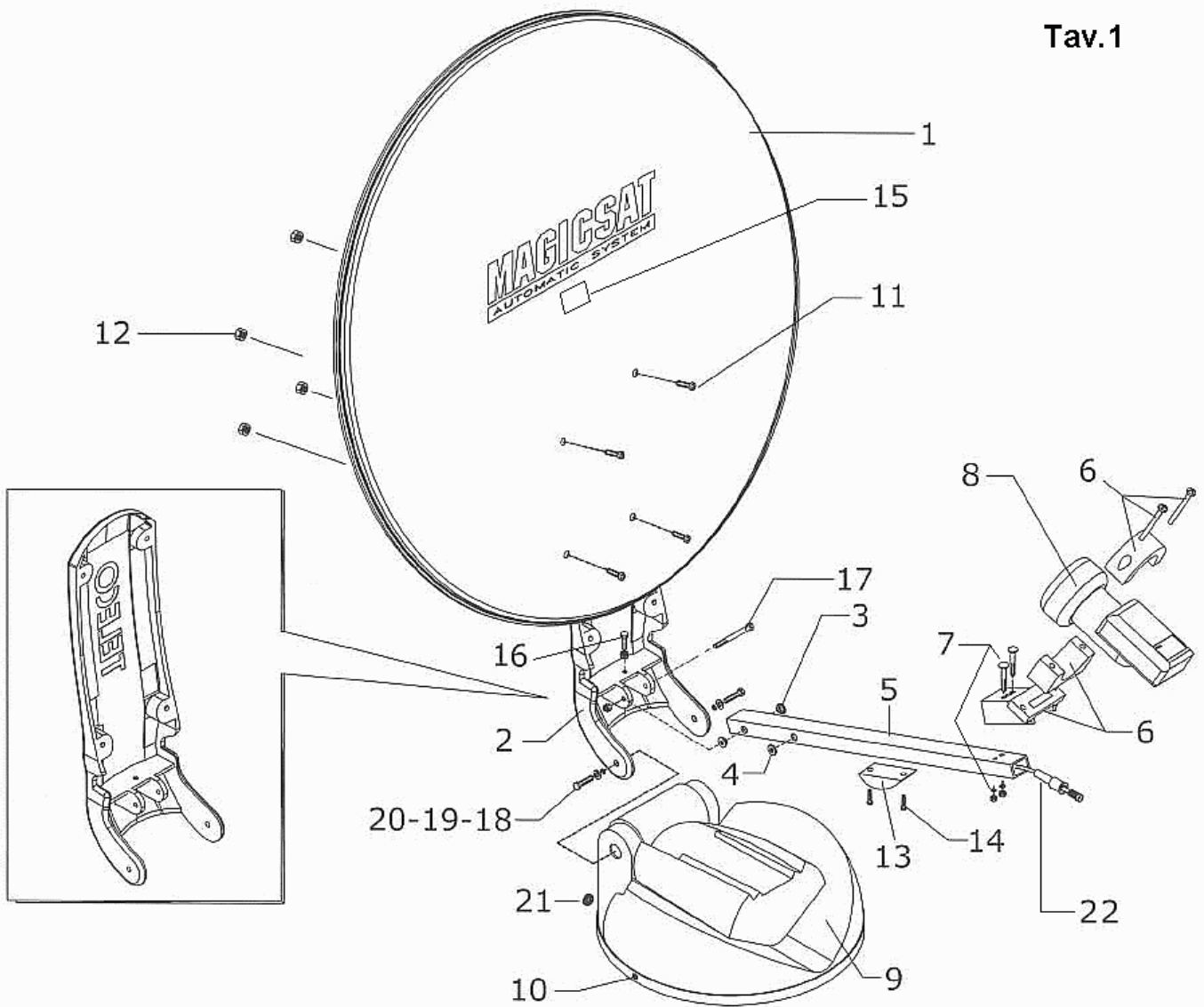

Pos	Code	Q.tà	Descrizione/Description	Dèsignation/Bezeichnung	Denomination/Description
1	03676	N.1	Disco parabola D=650mm Parabolic antenna D=650 mm	Antenne parabole D=650 mm Parabolspiegel D=650 mm	Schotel antenne D=650 mm Disco parabola D=650 mm
1	06681	N.1	Disco parabola D=500mm Parabolic antenna D=500 mm	Antenne parabole D=500 mm PARABOLSPIEGEL D=500 mm	Schotel antenne D=500 mm Disco parabola D=500mm
1	07364	N.1	Disco parabola D=850mm Parabolic antenna D=850 mm	Antenne parabole D=850 mm PARABOLSPIEGEL D=850 mm	Schotel antenne D=850 mm Disco parabola D=850mm
2	08993	N.1	Braccio di sostegno Magicsat 500 Support arm Magicsat 500	Bras de support pour Magicsat 500 TRAGARM FUR MAGICSAT 500	Steuerbeugel voor Magicsat 500 Brazo de soporte Magicsat 500
2	08992	N.1	Braccio di sostegno Magicsat 650/850 Support arm Magicsat 650/850	Bras de support pour Magicsat 650/850 TRAGARM FUR MAGICSAT 650/850	Steuerbeugel voor Magicsat 650/850 Brazo de soporte Magicsat 650/850
3	06076	N.1	Boccola nylon Nylon bush	Fourreau nylon NYLONBUCHSE	Nylon bus Casquillo nylon
4	05293	N.1	Passacavo gomma Hole grommet	Passa-fil caoutchouc KABELTULLE AUS GUMMI	Rubberen kabeldoorvoer Pasacable coucho
5	08994	N.1	Tubo supporto LNB Magicsat 650 (SLNB45) LNB Magicsat 650 support tube (SLNB45)	Tube support LNB Magicsat 650 (SLNB45) LNB-HALTEARM FUR MAGICSAT 650 (SLNB45)	LNB draagarm van Magicsat 650 (SLNB45) Tubo soporte LNB Magicsat 650 (SLNB45)
5	08995	N.1	Tubo supporto LNB Magicsat 850 (SLNB45) LNB Magicsat 850 support tube (SLNB45)	Tube support LNB Magicsat 850 (SLNB45) LNB-HALTEARM FUR MAGICSAT 850 (SLNB45)	LNB draagarm van Magicsat 850 (SLNB45) Tube soporte LNB Magicsat 850 (SLNB45)
5	08996	N.1	Tubo supporto LNB Magicsat 500 (SLNB45) LNB Magicsat 500 support tube (SLNB45)	Tube support LNB Magicsat 500 (SLNB45) LNB-HALTEARM FUR MAGICSAT 500 (SLNB45)	LNB draagarm van Magicsat 500 (SLNB45) Tubo soporte LNB Magicsat 500 (SLNB45)
6	08628	N.1	Supporto in plastica per LNB tipo Kombi completo Plastic support for Kombi-type LNB complet	Support en plastique pour LNB type Kombi Kunststoffhalterung fur LNB typ Kombi, Komplete	Plastic steun voor LNB type Kombi inclusief Soporte plastico para LNB tipo Kombi
7	09015	N.2	Dado M5 DIN 6923 inox Nut M5 DIN 6923 stainless steel	Ecrou M5 DIN 6923 inox Selbstsichernde Mutter M5 DIN 6923, rostfreier stahl	Zelfborgende moer M5 DIN 6923 inox Tuerca de seguridad M5 DIN 6923 inox
7	09014	N.2	Vite M5x30 UNI 5732 Screw M5x30 UNI 5732	Vis M5x30 UNI 5732 KOPFSCHRAUBE M5x30 UNI 5732	Schroef M5x30 UNI 5732 Tornillo M5x30 UNI 5732
8	06923	N.1	LNB Stark T1 LNB Stark T1	LNB Stark T1 LNB Stark T1	LNB Stark T1 LNB Stark T1
9	05468	N.1	Coperchio motore Engine cover	Capot moteur Motordeckel	Motorkap Tapa motor
10	07562	N.2	Rivetto autobloccante SR-3580-W Self-locking rivet SR-3580-W	Rivet autobloquant SR-3580-W Selbstsichernde niet SR-3580-W	Zelfborgende blindklinknagel SR-3580-W Remache de autobloqueo SR-3580-W
11	08595	N.4	Vite 5x14 testa cilindrica inox Stainless stell cheese-headed screw 5x14	Vis 5x14 tete cylindrique inox Zylinderschraube 5x14 aus rostfreiem stahl	Schroef 5x14 cilinderkop rvs Tronillo 5x14 cabeza cilindrica inox
11	10909	N.4	Vite M6x14 UNI7687 DIN7985 inox Screw M6x14 UNI7687 DIN7985 stainless steel	Vis M6x14 UNI7687 DIN7985 inox Schraube M6x14 UNI7687 DIN7985, rostfreier stahl	Schroef M6x14 UNI7687 DIN7985 inox Tornillo M6x14 UNI7687 DIN7985 inox
12	03685	N.4	Dado auto-bloccante M5 UNI7474 inox Self-locking nut M5 UNI7474 stainless steel	Ecrou autobloquant M5 UNI7474 inox Selbstsichernde Mutter M5 UNI7474, rostfreier stahl	Zelfborgende moer M5 UNI7474 inox Tuerca de seguridad M5 UNI7474 inox
12	03684	N.4	Dado auto-bloccante M6 UNI 7474 inox Stainless steel self-locking nut M6 UNI 7474	Ecrou autobloquant M6 UNI 7474 inox Selbstsichernde Mutter M6 UNI 7474, rostfreier stahl	Zelfborgende moer M6 UNI 7474 inox Tuerca de seguridad M6 UNI 7474 inox
13	06045	N.1	Culla nera Black cradle	Berceau noir TRAGER SCHWARZ	Wieg zwart Apoyo negro
14	06732	N.2	Rivetto 2.4x10 Allum. Rivet 2.4x10	Rivet 2.4x10 Niet 2.4x10	Blindklinknagel 2.4x10 Remache 2.4x10
15	05735	N.1	Gommino trasparente Transparent rubber	Gomme transparente Transparenter Gummi	Transparent rubber Caucho transparente
16	07111	N.1	Grano M6x10 D=500 M6x10 screw D=500	Vis M6x10 D=500 Schraube M6x10 D=500	Schroef M6x10 D=500 Esparrago M6x10 D=500
16	05280	N.1	Grano M6x16 D=650-850 M6x16 screw D=650-850	Vis M6x16 D=650-850 Schraube M6x16 D=650-850	Schroef M6x16 D=650-850 Esparrago M6x16 D=650-850
17	04441	N.1	Vite 6x60 MA testa esagonale inox Stainless 6x60 MA steel hexagonal-head screw	Vis 6x60 MA tete hexagonale inox Sechskantschraube 6x60 MA aus rostfreiem stahl	Schroef 6x60 MA cilinderkop rvs Tornillo 6x60 MA cabeza hexagonal inox
18	09773	N.2	Vite M8x25 inox Screw M8x25 stainless steel	Vis M8x25 inox Schraube M8x25, rostfreier stahl	Schroef M8x25 inox Tornillo M8x25 inox

19	09775	N.2	Rondella D=8 piana inox Stainless steel flat D=8 washer	Rondelle D=8 plate inox SCHEIBE D=8 FLACH, AUS ROSTFREIEM STAHL	Onderlegring D=8 plat inox Arandela D=8 plana inox
20	09774	N.2	Rondella D=8 inox dent.est. Washer D=8 stainless steel	Rondelle D=8 inox SCHEIBE D=8, rostfreier stahl	Onderlegring D=8 inox Arandela D=8 inox
21	05696	N.1	Controdado Lock nut	Contre-ecrou Gegenmutter	Contraoer Contrauerca
21	05697	N.1	Guarnizione PG7 Gasket PG7	Joint PG7 Dichtung PG7	Afdichting PG7 Junta PG7
21	05695	N.1	Passacavo skintop PG7 Fairlead skintop PG7	Passe-fil skintop PG7 Kabeltulle skintop PG7	Kabeldoorvoer skintop PG7 Pasacable skintop PG7
22	03459	N.1	Gommino protezione connettore Connector rubber top	Caoutchouc de protection connecteur VERBINDERSCHUTZGUMMI	Beschermingsrubber stekker Proteccion de caucho para conector

MagicSat Easy

Tav.2

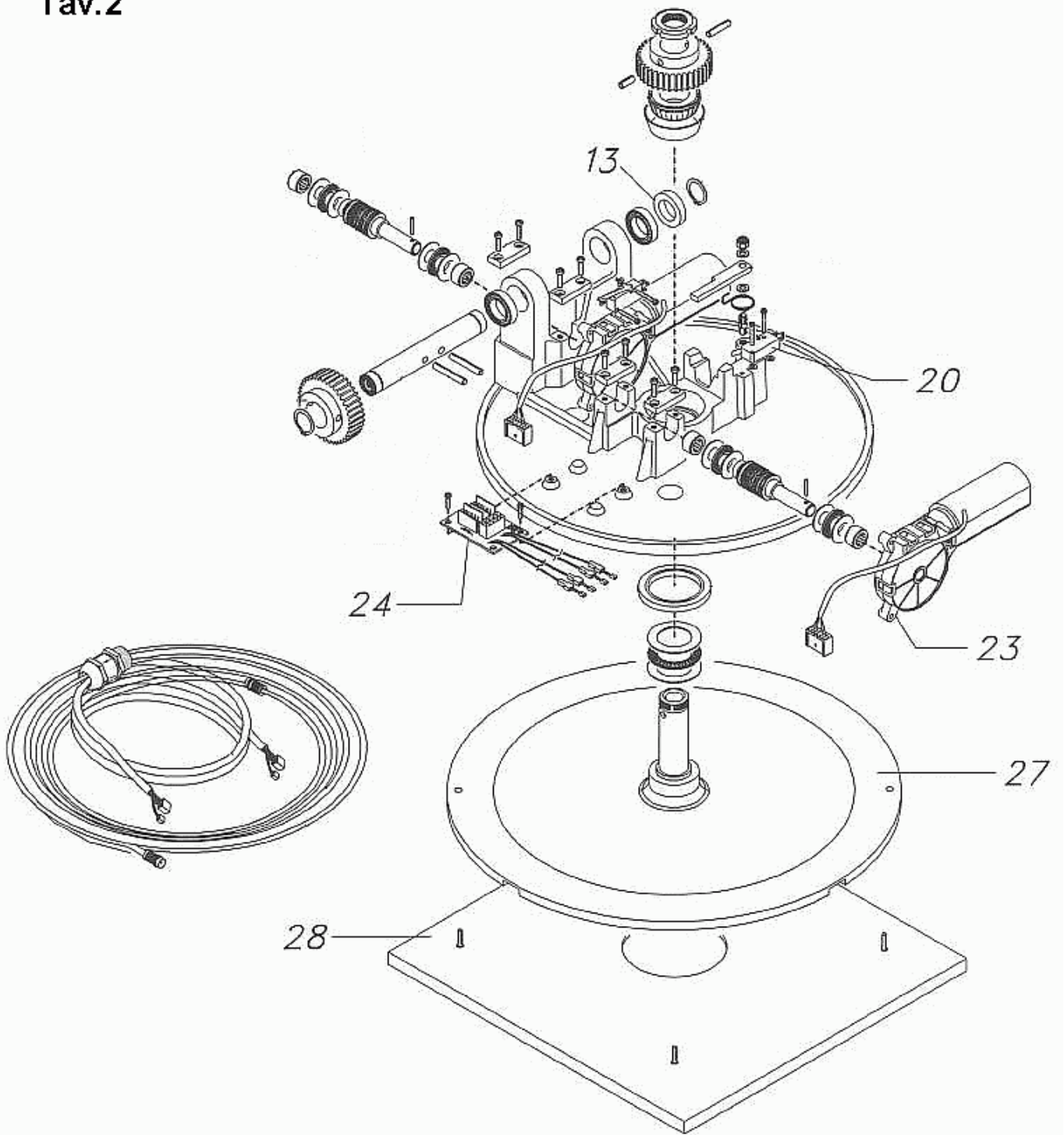

(Tav. 2 - Vers. 2 del 20/01/2012)

Pos	Code	Q.tà	Descrizione/Description	Désignation/Bezeichnung	Denomination/Descripcion
13	06037	N.2	Guarnizione laterale Side gasket	Joint lateral SEITLICHE DICHTUNG	Zijafdichting Junta lateral
20	04761	N.2	Microinterruttore a tenuta stagna Waterproof microswitch	Microcontact etanche MIKROSCHALTER, DICHT	Microschakelaar in stor- en waterdichte uit Microinterruptor estanco
23	11161	N.2	Motore elettrico Electric motor	Moteur électrique Elektrischer Getriebemotor	
24	12945	N.1	Basetta supporto connettori 4+6 pin Connector strip	Base de support pour connecteurs KLEMMLEISTE FÜR VERBINDER	Steunplaat connectoren Base soporte conectores
27	05384	N.1	Piastra base Base plate	Plaque de base BASISPLATTE	Onderplaat Placa de base
28	08997	N.1	Piastra di montaggio rettangolare Assembly rectangular plate	Plaque de montage Montageplatte	Montageplaat Placa de sujecion

MagicSat Easy

Tav. 3

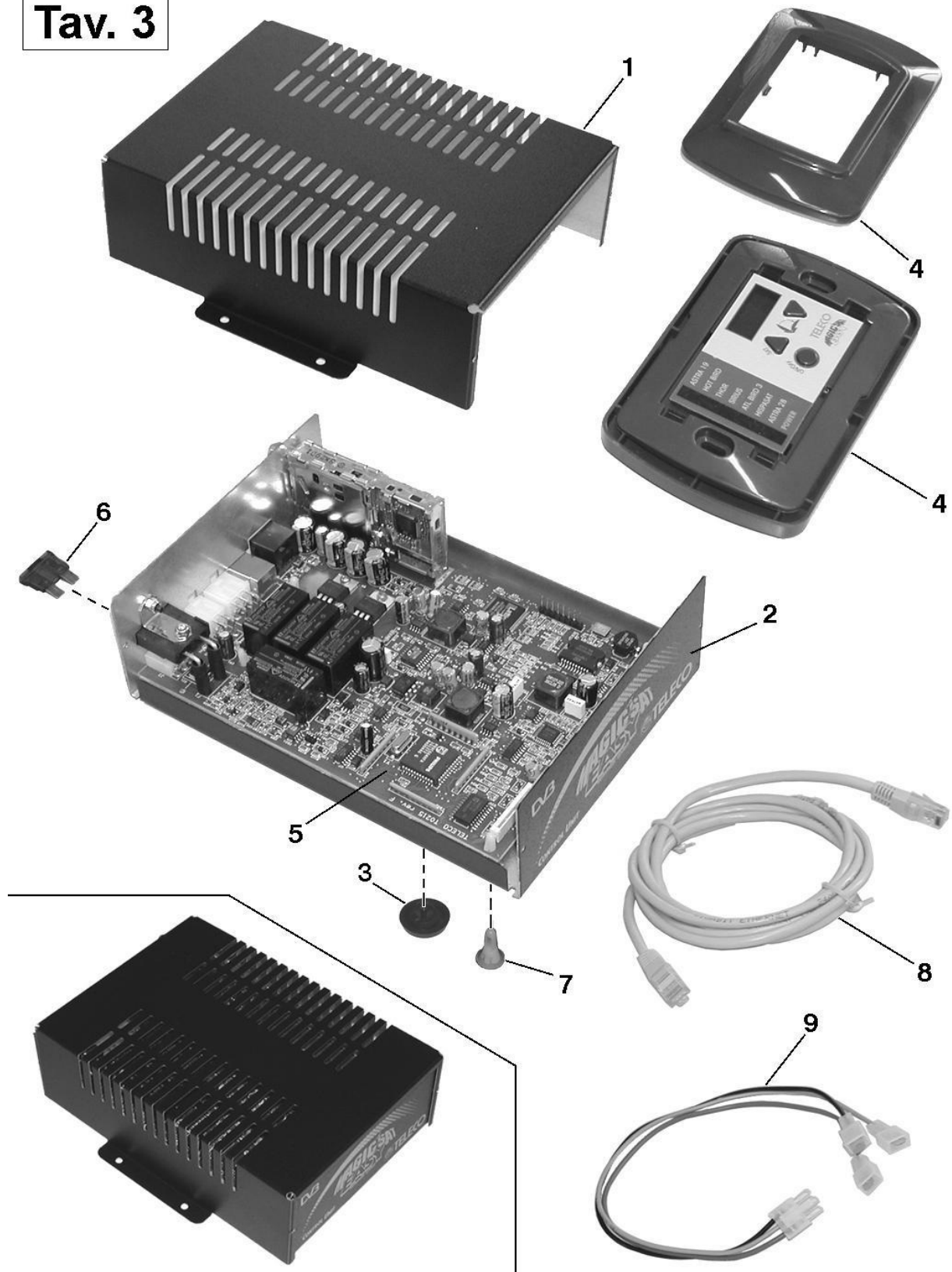

(Tav. 3 - Vers. 2 del 20/01/2012)

Pos	Code	Q.tà	Descrizione/Description	Dèsignation/Bezeichnung	Denomination/Descripcion
1	14897	N.1	Coperchio unita' comando Control unit lid	Capot boîte/comm. Deckel Steuereinheit	Kap bedieningsunit Tapa unidad de mando
2	14896	N.1	Fondo unita' comando Control unit bottom	Fond boîte/comm. Boden Steuereinheit	Onderkant bedieningsunit Fondo unidad de mando
3	09835	N.4	Piedino nero in gomma Black rubber foot	Pied noir en caoutchouc Schwarzer Gummifuß	Zwart rubber pootje Pie negro de caucho
4	15095	N.1	Pannello di controllo Control panel	Tableau de contrôle Bedientafel	Bedieningspaneel Panel de control
5	14904	N.1	Scheda T0215 REV.N T0215 board REV.N	Carte T0215 REV.N Karte T0215 REV.N	Printplaat T0215 REV.N Tarjeta T0215 REV.N
6	09705	N.1	Fusibile 5A 5A Fuse	Fusible 5 A Sicherung 5A	Zekering 5A Fusible 5A
7	01458	N.4	Supporto Support	Support Kunststoffhalterung	Steun voor Soporte
8	11742	N.1	Cavo PATCH UTP PATCH UTP Cable	Câble PATCH UTP Kabel PATCH UTP	Kabel PATCH UTP Cable PATCH UTP
9	09318	N.1	Cavo alimentazione Power supply cable	Câble d'alimentation Versorgungskabel	Voedingskabel Cable de alimentación

MagicSat Easy

Tav. 4

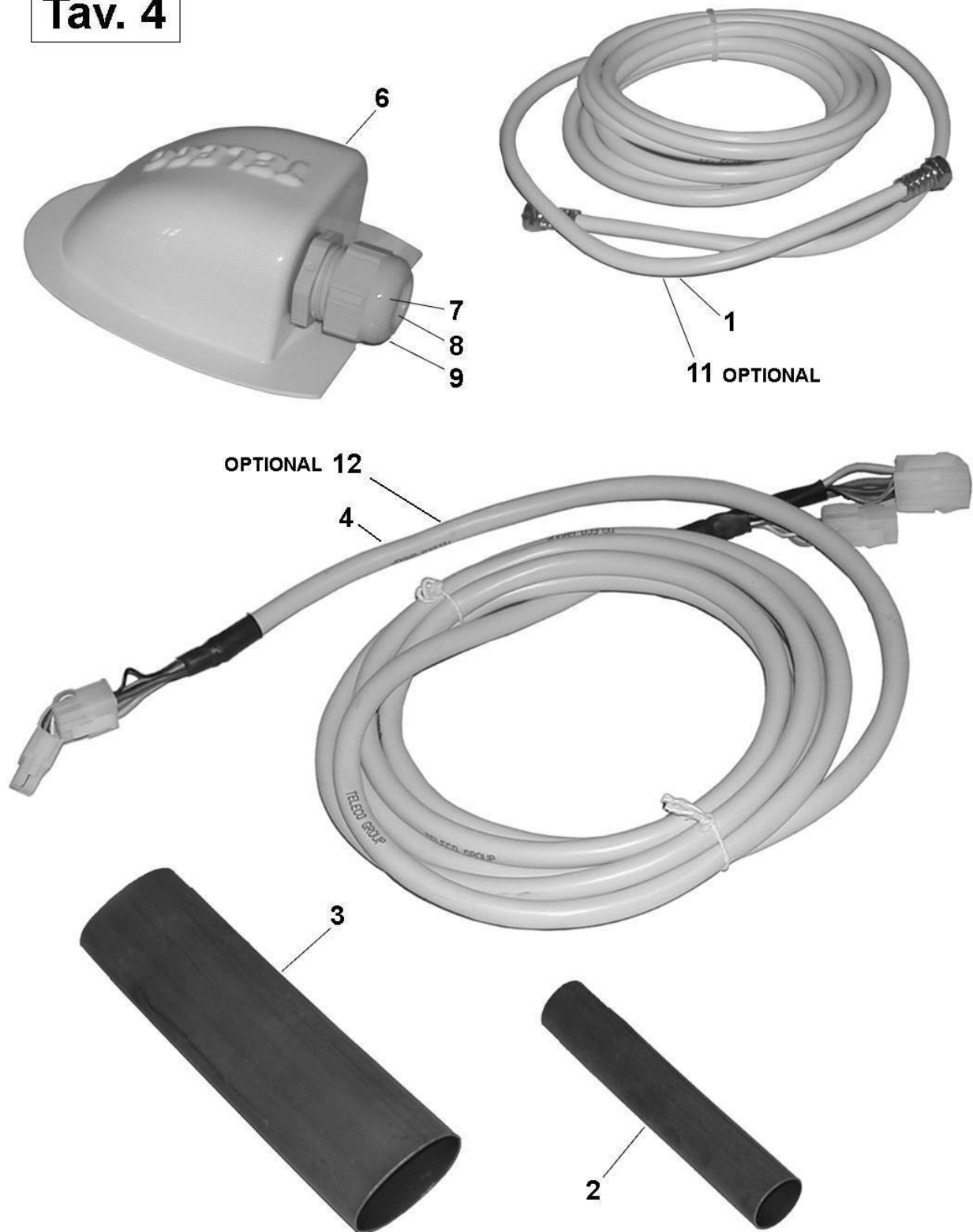

(Tav. 4 - Vers. 2 del 20/01/2012)

Pos	Code	Q.tà	Descrizione/Description	Désignation/Bezeichnung	Denomination/Description
1	05950	N.1	Cavo coassiale 3mt con connet. F/F 3 m coax cable F/F.connector	Cable coaxial 3 m avec connecteur F/F KOAXIALKABEL 3 m MIT F-FVERBINDER	Coaxkabel 3m inclusief F/F-connector Cable coaxial 3mt con conect F/F
2	03598	N.1	Guaina termorestringente Shrink-wrap sheath	Gaine thermoretractible MANTEL, WARMESCHRUMPFEND	Krimpkous Vaina termorretractil
3	03597	N.1	Guaina ternorestringente Shrink-wrap sheath	Gaine thermoretractible MANTEL, WARMESCHRUMPFEND	Krimpkous Vaina termorretractil
4	09300	N.1	Cavo 10 poli 3mt contr. gruppo motore con conn 10-core 3mt engine unit cont. cable w/connecto	Cable 10 poles 3mt contr. groupe moteur avec conn 10-POLIGES 3mt STEUERKABEL MOTOREINHEIT	Besturingskabel motoreenheid 10-polig 3mt incl. Cable 10 polos 3mt contr. grupo motor con con.
6	08864	N.1	Copri cavi abs bianco Cable cover abs	Capot cable abs Kabeldeckel abs	kapkabel abs Tapa cables abs
7	06900	N.1	Guarnizione O-SEALING VITON PG21 Gasket O-SEALING VITON PG21	Joint O-SEALING VITON PG21 Dichtung O-SEALING VITON PG21	Afdichting O-SEALING VITON PG21 Junta O-SEALING VITON PG21
8	06901	N.1	Pressacavo SKINTOP PG21 SKINTOP cable gland PG21	Serre-câble SKINTOP PG21 Kabelschelle SKINTOP PG21	Kabelklem SKINTOP PG21 Prensacable SKINTOP PG21
9	06898	N.1	Controdado SKINTOP PG21 SKINTOP plastic nut PG21	Ecrou plastique SKINTOP PG21 Kunststoffmutter SKINTOP PG21	Moer plastic SKINTOP PG21 Tuerca plástico SKINTOP PG21
11	07883	N.1	Cavo coassiale 9mt con connet. F/F 9 m coax cable F/F.connector	Cable coaxial 9 m avec connecteur F/F KOAXIALKABEL 9 m MIT F-FVERBINDER	Coaxkabel 9m inclusief F/F-connector Cable coaxial 9mt con conect F/F
11	07294	N.1	Cavo coassiale 5mt con connet. F/F 5 m coax cable F/F.connector	Cable coaxial 5 m avec connecteur F/F KOAXIALKABEL 5 m MIT F-FVERBINDER	Coaxkabel 5m inclusief F/F-connector Cable coaxial 5mt con conect F/F
11	08998	N.1	Cavo coassiale 2mt con connet. F/F 2 m coax cable F/F.connector	Cable coaxial 2 m avec connecteur F/F KOAXIALKABEL 2 m MIT F-FVERBINDER	Coaxkabel 2 m inclusief F/F-connector Cable coaxial 2mt con conect F/F
12	09765	N.1	Cavo 10 poli 2mt contr. gruppo motore con conn 10-core 2mt engine unit cont. cable w/connecto	Cable 10 poles 2mt contr. groupe moteur avec conn 10-POLIGES 2mt STEUERKABEL MOTOREINHEIT	Besturingskabel motoreenheid 10-polig 2mt incl. Cable 10 polos 2mt contr. grupo motor con con.
12	09301	N.1	Cavo 10 poli 5mt contr. gruppo motore con conn 10-core 5mt engine unit cont. cable w/connecto	Cable 10 poles 5mt contr. groupe moteur avec conn 10-POLIGES 5mt STEUERKABEL MOTOREINHEIT	Besturingskabel motoreenheid 10-polig 5mt incl. Cable 10 polos 5mt contr. grupo motor con con.
12	09302	N.1	Cavo 10 poli 9mt contr. gruppo motore con conn 10-core 9mt engine unit cont. cable w/connecto	Cable 10 poles 9mt contr. groupe moteur avec conn 10-POLIGES 9mt STEUERKABEL MOTOREINHEIT	Besturingskabel motoreenheid 10-polig 9mt incl. Cable 10 polos 9mt contr. grupo motor con con.



CONFORMITY CERTIFICATE

The manufacturer Teleco Spa

Via Majorana nr. 49, 48022 Lugo (RA)

Declares under its own responsibility that the following products:

Magic Sat Easy

which are the subject of this certificate, conform to the following norms:

EN 60065: 2002
EN 55013: 2001 + A1: 2003
EN 61000 – 3 - 2: 2000 + A2: 2500
EN 61000 – 3 – 3: 1995 + A1: 2001 + A2: 2005
EN 55020: 2002 + A2: 2005

according to the terms of the European directive 2006/95/EC
Low Voltage (modified by 93/68/CEE) and
2004/108/CEE of Electromagnetic Compatibility
(modified by 92/31/CEE e 93/68/CEE)
of the European Parliament.

Lugo 01 / 10 / 2010

THE PRESIDENT

Ing. Raul Fabbri



Group
TELECO



 **TELECO** SPA

ITALY

Via E. Majorana 49
48022 LUGO (RA)
Tel. + 39 0545 25037
Fax. + 39 0545 32064
mail: info@telecogroup.com
www.telecogroup.com
Assistenza 899 899 856

 **TELECO** GmbH

DEUTSCHLAND

82041 Deisenhofen
Tel. 08031 98939
Fax 08031 98949
telecogmbh@telecogroup.com
www.telecogroup.com

 **TELECO** SAS

FRANCE

3, Impasse des Iles
ZA La Maladière
07300 St Jean de Muzols
mail: contact@telecogroup.fr
www.telecogroup.fr

Telair SRL

ITALY

Via E. Majorana 49
48022 LUGO (RA)
Tel. + 39 0545 25037
Fax. + 39 0545 32064
mail: telair@telecogroup.com
www.telecogroup.com

IN EUROPE:

GREAT BRITAIN - SCAN TERIEUR LTD
30, The Metro Centre, Tolpits Lane - Watford,
Herts - England - WD18 9XG
Tel. 01923 800353 - Fax 01923 220358
e-mail: info@scan-terieur.com
www.scan-terieur.com

THE NETHERLANDS/BELGIUM/LUXEMBOURG/DENMARK/SWEDEN
KARMAN TRADING
Tel. +31 (0) 341 722450 - Fax +31 (0) 341 722451
e-mail: info@karmantrading.eu
www.karmantrading.eu

FRANCE - TELECO SAS
3, impasse des Iles - ZA La Maladière
07300 St Jean de Muzols - France
Tél. 04 75 08 49 17 - Fax 09 70 32 83 00
contact@telecogroup.fr
www.telecogroup.fr

SERVICE COMMERCIAL :
Jean-Philippe Bleys
Tél. 02 48 58 03 67 Fax 02 48 58 35 85
teleco.telair@bleysed.com
Service Technique :
Tél. 06 83 31 44 05 ou 04 75 08 28 25

ESPAÑA - NAUCCA CARAVANING S.A.
Polígono Industrial CAN ROQUETA 2
Calle Can Lletget, nº 2 - 08202 Sabadell - Barcelona
Tel. 937 457 054 - Fax. 937 254 484
e-mail: comercial@naucca.com
Servicio técnico: Fills de Rocha i Lopez, S.L- C/Goya,4
08903 L'Hospitalet de Llogrebat - Barcelona - España
Tel. 933 333 753 - Fax 933 337 236
fillsrocha@fillsrocha.com

ÖSTERREICH - TELECO GmbH
82041 Deisenhofen - Deutschland
Tel. 0049 8031 98939 - Fax. 0049 8031 98949
telecogmbh@telecogroup.com
www.telecogroup.com
SERVICE 0900 94 94 70

DEUTSCHLAND - TELECO GmbH
82041 Deisenhofen - Deutschland
Tel. 08031 98939 - Fax 08031 98949
telecogmbh@telecogroup.com
www.telecogroup.com
VERTRETUNG:

Zimmer - Technik für Mobile Freizeit
Raiffeisenstr. 6 - 64347 Griesheim
Tel. 06155 797873 - Fax 06155 797871
info@zimmer-mobiltechnik.de
SERVICE 08921129997

Foto e disegni non contrattuali - Les photos et les dessins ne sont donnés qu'à titre indicatif - We reserve the right to make technical changes without prior notice - Fotos und Zeichnungen nicht vertraglich - Foto's en tekeningen niet contractueel - Fotos y planos no indicados en contrato



30_09_13